

| <b>BAYPORT LANDING</b>                                                                                                     |       |              |          |            |         | Inspected by:   |                 |               | Inspected November 2008 |         |          |                            |
|----------------------------------------------------------------------------------------------------------------------------|-------|--------------|----------|------------|---------|-----------------|-----------------|---------------|-------------------------|---------|----------|----------------------------|
| INSTRUCTIONS: Please <b>CHECK</b> the appropriate boxes below that reflect your evaluation of the particular road section. |       |              |          |            |         |                 |                 |               |                         |         |          |                            |
| Street                                                                                                                     | Route | Old Pavement | Cracking | Alligating | Sinking | Uneven Pavement | Utility Failure | OVERALL GRADE |                         |         |          | Notes                      |
|                                                                                                                            |       |              |          |            |         |                 |                 | A (Good)      | B (Fair)                | C (Bad) | D (Poor) |                            |
| Bayport Landing Road                                                                                                       | 3215  | X            | X        | X          | X       |                 | X               |               | ✓                       |         |          | Reference map sent to VDOT |
| Bayport Landing Terrace                                                                                                    | 3217  | X            | X        | X          |         |                 |                 |               | ✓                       |         |          |                            |
| Bayport Landing Court                                                                                                      | 3216  | X            |          | X          |         | X               |                 |               |                         | ✓       |          |                            |
| INSTRUCTIONS: Please <b>IDENTIFY THE PERTINENT SECTION OF THE ROAD</b> when writing comments below.                        |       |              |          |            |         |                 |                 |               |                         |         |          |                            |
| <b>EVALUATION NOTES</b>                                                                                                    |       |              |          |            |         |                 |                 |               |                         |         |          |                            |
| <b>3215</b> - Some cracking at entrance. Combination of alligating and cracking between 13919 and 13912.                   |       |              |          |            |         |                 |                 |               |                         |         |          |                            |
| Patch work poor at 13915. Extreme alligating at the end of the road                                                        |       |              |          |            |         |                 |                 |               |                         |         |          |                            |
| Utility failure at 13907.                                                                                                  |       |              |          |            |         |                 |                 |               |                         |         |          |                            |
|                                                                                                                            |       |              |          |            |         |                 |                 |               |                         |         |          |                            |
| <b>3217</b> - cracking and alligating throughout, especially at 14002,14004,14006-14010 14014                              |       |              |          |            |         |                 |                 |               |                         |         |          |                            |
|                                                                                                                            |       |              |          |            |         |                 |                 |               |                         |         |          |                            |
| <b>3216</b> - Extreme alligating overall. Holes in front of 5805 and 5806                                                  |       |              |          |            |         |                 |                 |               |                         |         |          |                            |
|                                                                                                                            |       |              |          |            |         |                 |                 |               |                         |         |          |                            |
|                                                                                                                            |       |              |          |            |         |                 |                 |               |                         |         |          |                            |
|                                                                                                                            |       |              |          |            |         |                 |                 |               |                         |         |          |                            |
|                                                                                                                            |       |              |          |            |         |                 |                 |               |                         |         |          |                            |

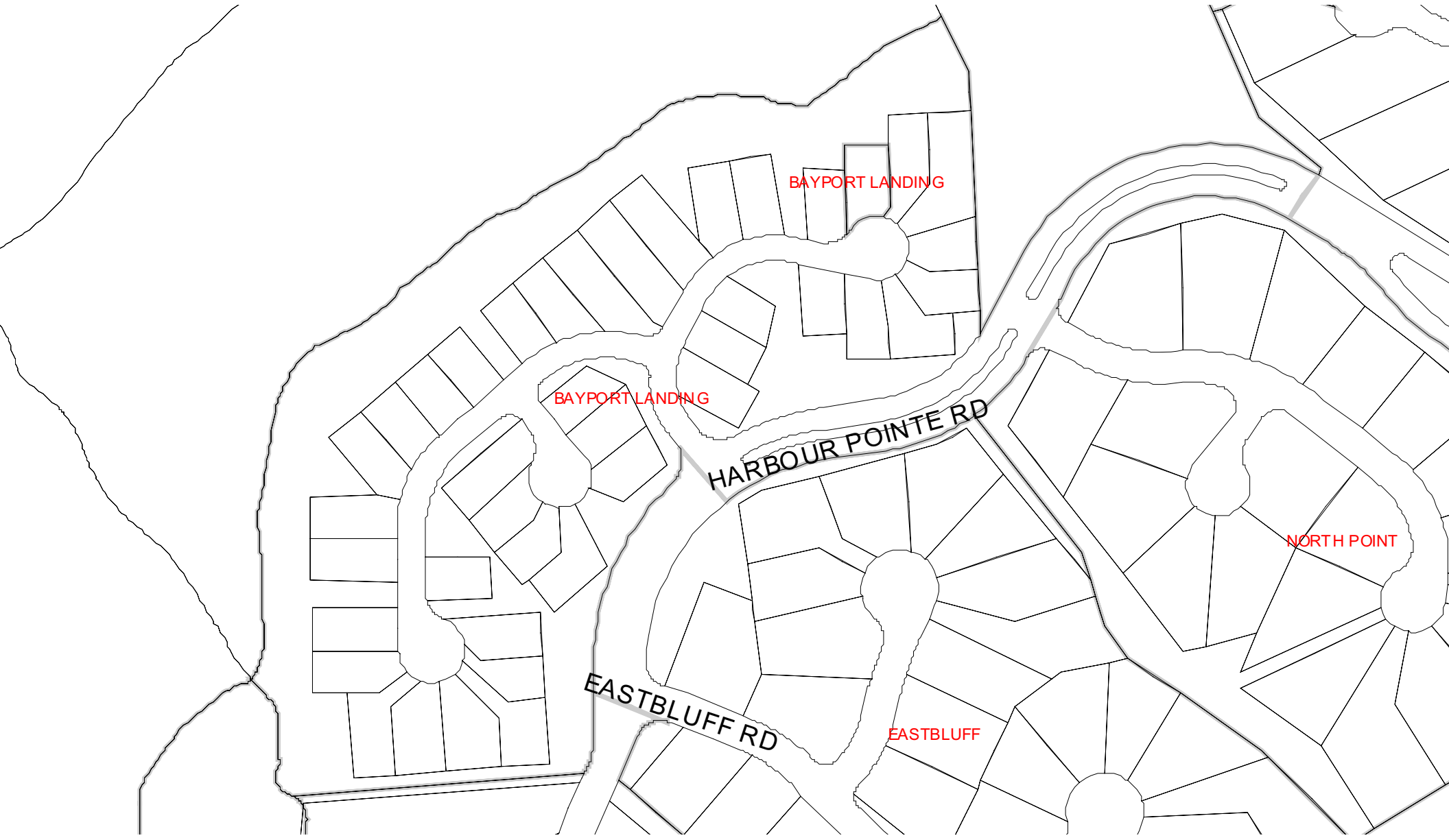

BAYPORT LANDING

BAYPORT LANDING

HARBOUR POINTE RD

EASTBLUFF RD

EASTBLUFF

NORTH POINT