

EASTBLUFF	Inspected by:	Inspected November 2008
------------------	---------------	-------------------------

INSTRUCTIONS: Please **CHECK** the appropriate boxes below that reflect your evaluation of the particular road section.

Street	Route	Old Pavement	Cracking	Alligating	Sinking	Uneven Pavement	Utility Failure	OVERALL GRADE				Notes
								A (Good)	B (Fair)	C (Bad)	D (Poor)	
Eastbluff Road	3858		X	X					✓			Reference map sent to VDOT
Eastbluff Court	3859		X	X					✓			

INSTRUCTIONS: Please **IDENTIFY THE PERTINENT SECTION OF THE ROAD** when writing comments below.

EVALUATION NOTES

3858 - Extensive alligating at intersection. Cracking between 14004 and 13919 as well as around utility covers.

Cul-de-sac has moderate alligating

3859 - Extensive cracking in cul-de-sac, alligating at 5911,5908,5903.

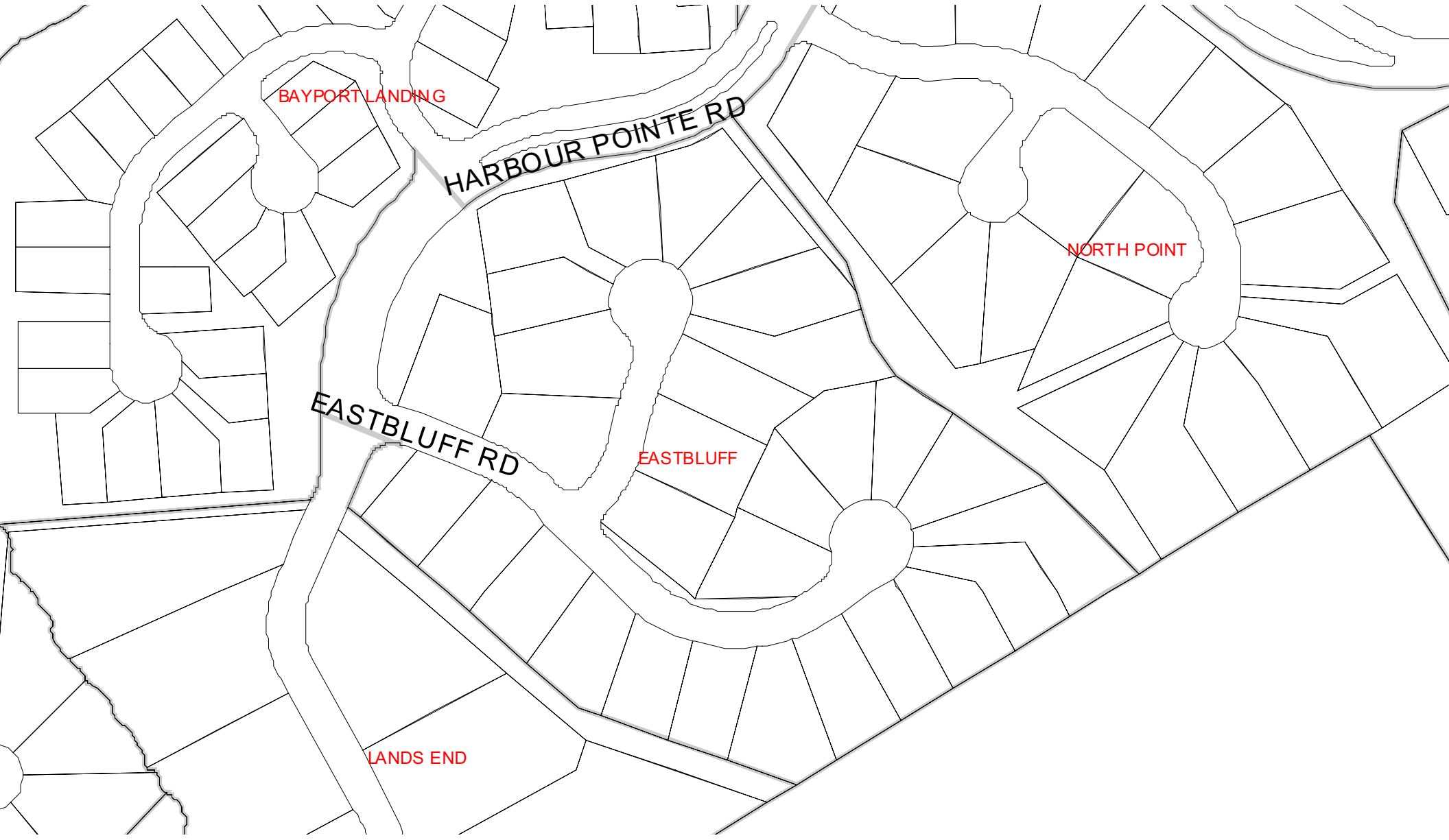

BAYPORT LANDING

HARBOUR POINTE RD

NORTH POINT

EASTBLUFF RD

EASTBLUFF

LANDS END