

<b>NORTH POINT</b>	Inspected by:	Inspected November 2008
--------------------	---------------	-------------------------

INSTRUCTIONS: Please **CHECK** the appropriate boxes below that reflect your evaluation of the particular road section.

Street	Route	Old Pavement	Cracking	Alligating	Sinking	Uneven Pavement	Utility Failure	OVERALL GRADE				Notes
								A (Good)	B (Fair)	C (Bad)	D (Poor)	
North Point Road	3213		X	X					✓			
North Point Court	3214		X	X					✓			

INSTRUCTIONS: Please **IDENTIFY THE PERTINENT SECTION OF THE ROAD** when writing comments below.

### EVALUATION NOTES

3214 - extensive alligating at intersection of 3213 and 3214. Some cracking throughout

---



---



---



---



---



---



---



---



---



---



---



---

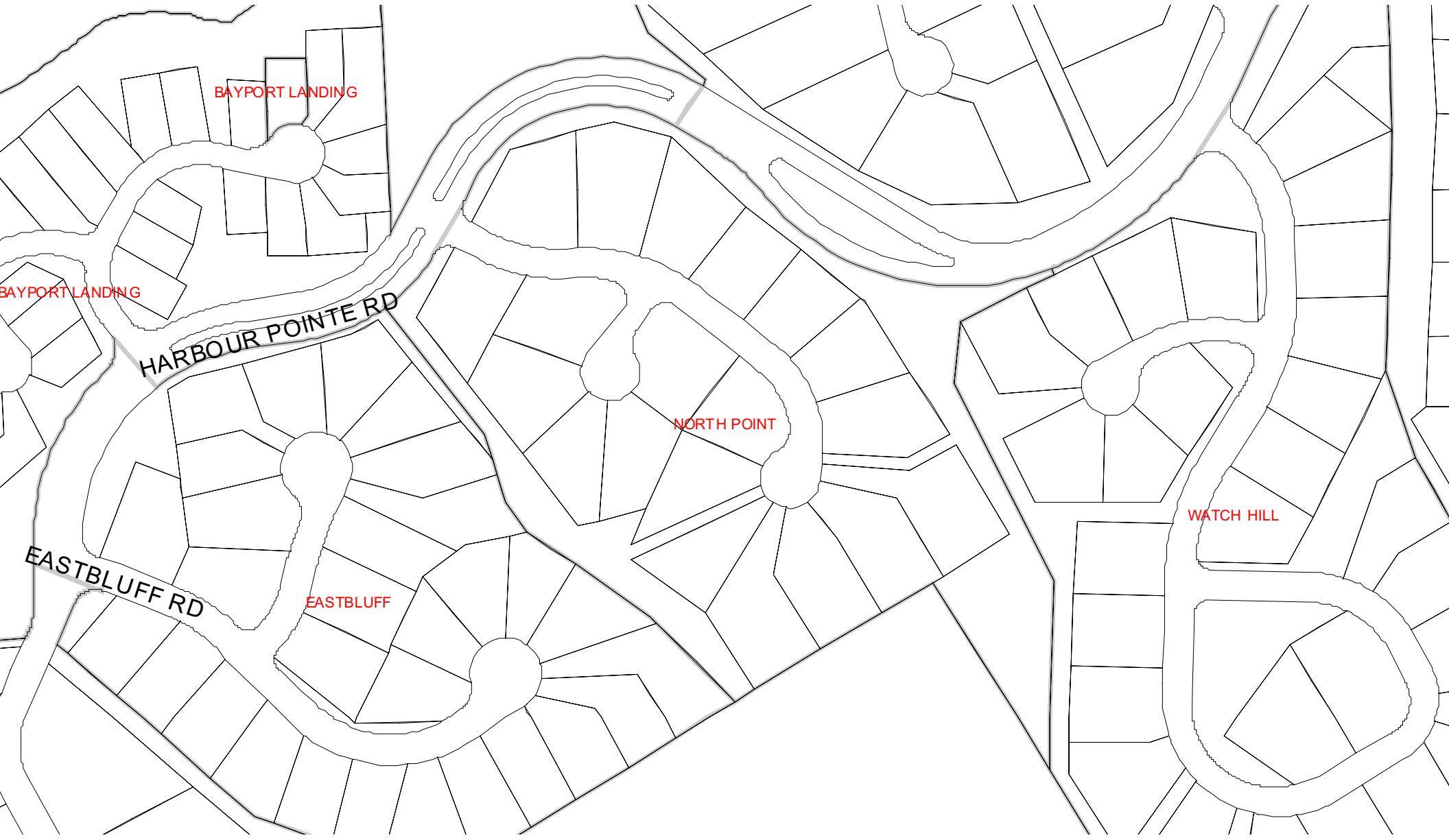

BAYPORT LANDING

BAYPORT LANDING

HARBOUR POINTE RD

EASTBLUFF RD

EASTBLUFF

NORTH POINT

WATCH HILL